

PTD-100 temperature sensor kit - order separately

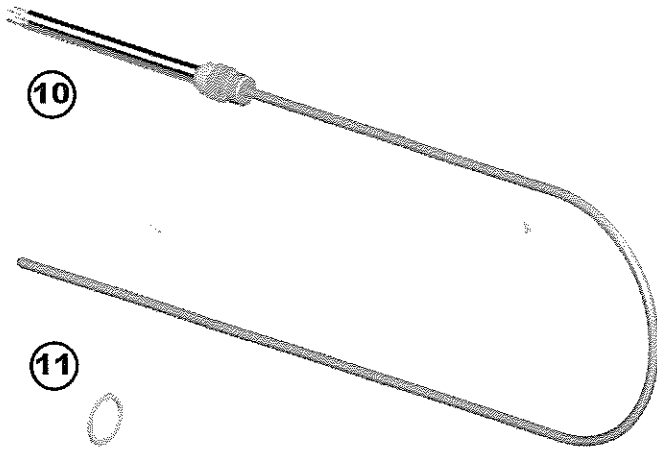

B-type banding - order separately

B-4: for pipes up to 4"  
B-10: for pipes up to 10"  
B-21: for pipes up to 21"

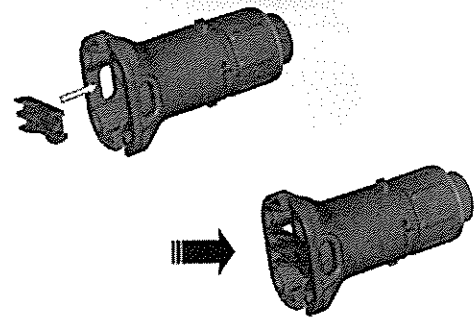
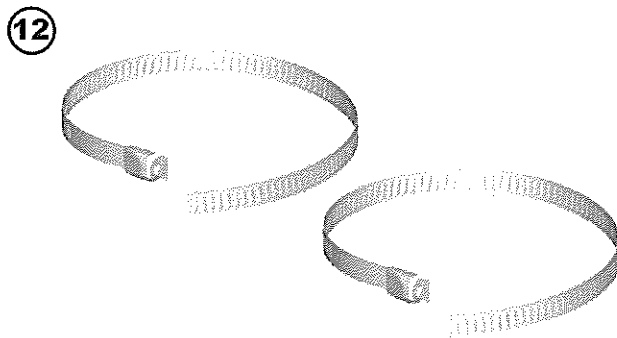

1. Insert banding guide into expediter and snap into place.

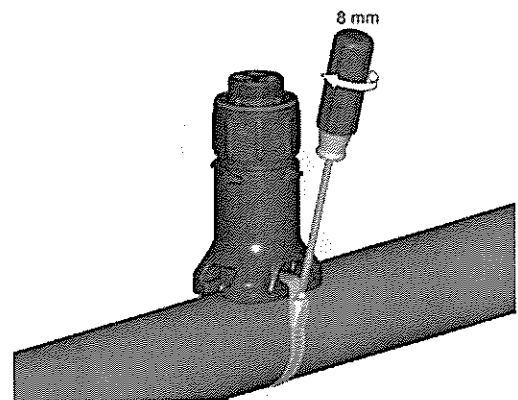

2. Mount expediter to pipe using pipe band.

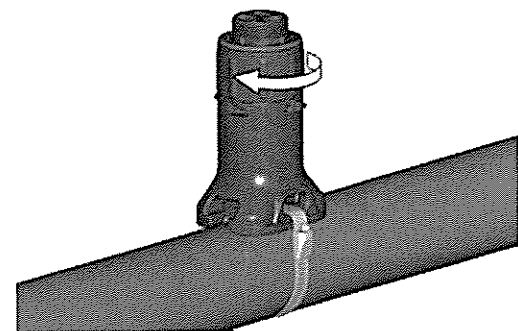

3. Tighten cap securely.

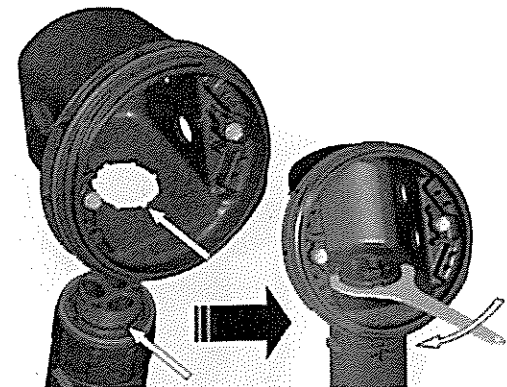

4. Mount junction box base on expediter. Make sure to align slots to properly orient junction box base. Tighten nut with Terminator-LN-Tool.